

HB

Opt
Ext
Door

Opt
Summer
Kitchen

Covered Lanai
34'2" x 13'0"

Master Suite
14'6" x 17'0"
Coffered Ceiling

5'-0" HIGH PRIVACY
WALL W/ OPT. SUMMER
KITCHEN

Transom

Dining
13'8" x 13'2"

Great Room
20'8" x 17'10"

Master Bath

Transom

WIC

Suite 3
11'0" x 12'2"

Kitchen
16'4" x 10'8"

WIC

Opt
Den
Doors

Den
13'10" x 12'0"

Opt
Wall Oven

Transom

Bath 3

Laundry

Opt Cab
& LI

Opt Drop
Zone

22" x 36"
A/Ric Access

A/C

Three Car Garage
27'8" x 21'0"

Foyer
Coffered
Ceiling

Bath 2

Electrical
Panel

22" x 36"
A/Ric Access

Bedroom 2
14'0" x 10'8"

HB

**Covered
Entry**

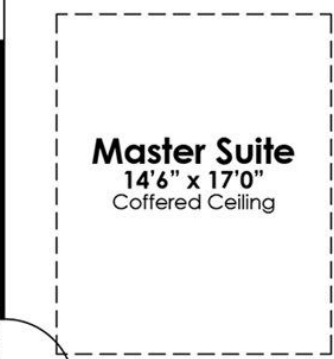
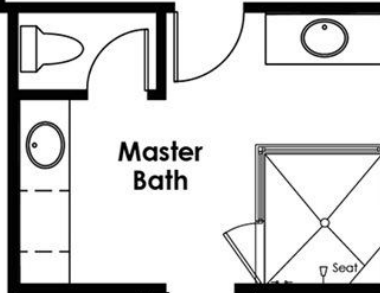
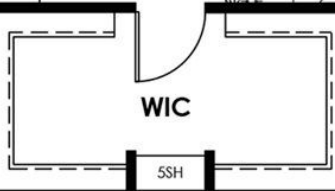
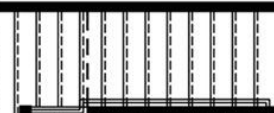
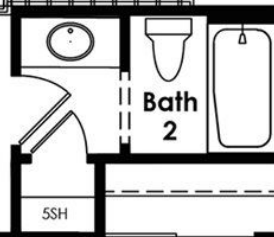
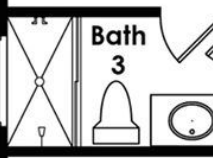
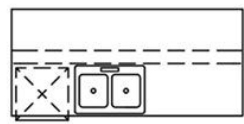
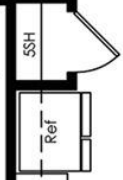
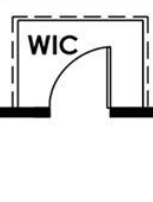
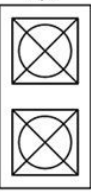

Transom

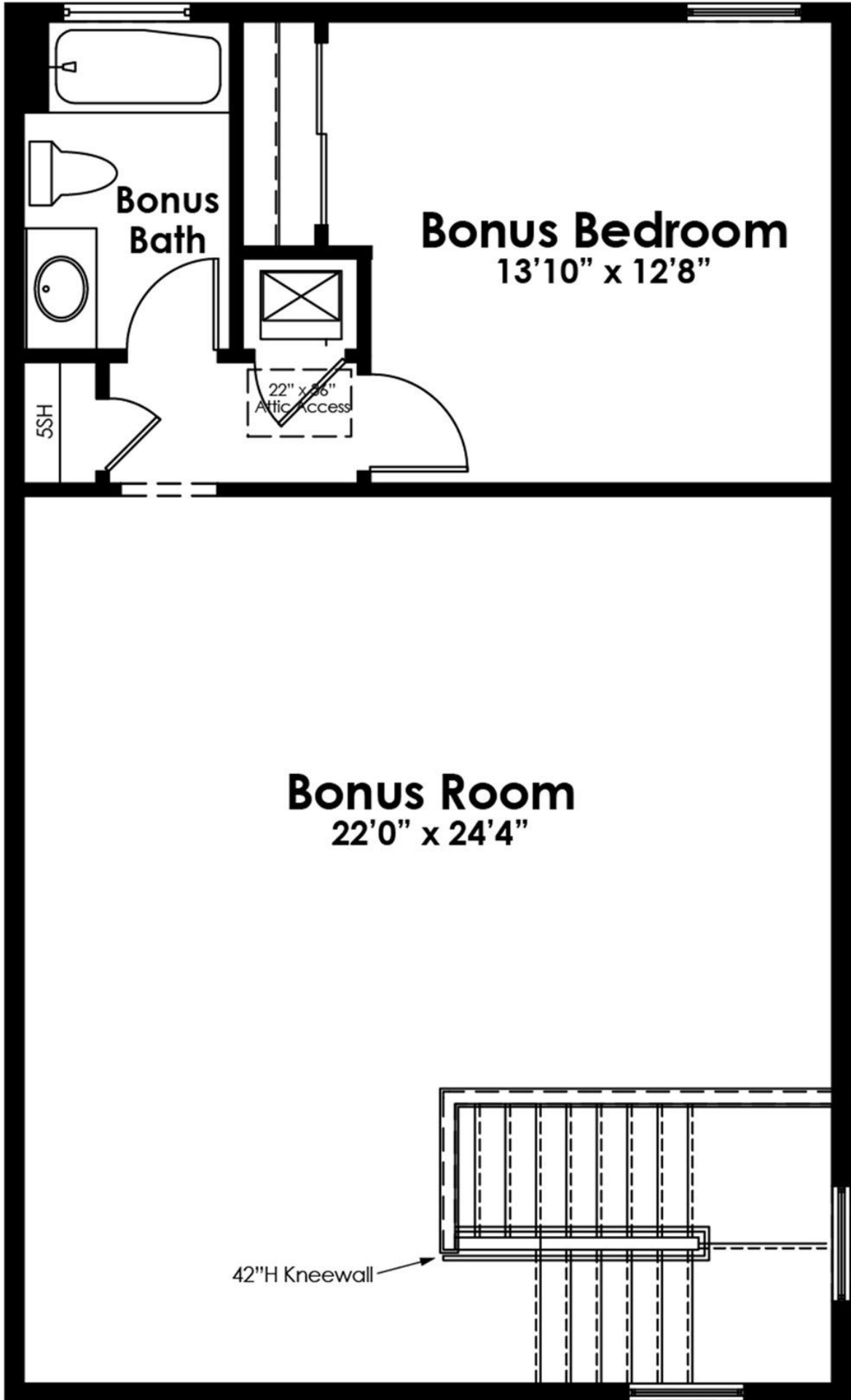

Bonus Bath

Bonus Bedroom
13'10" x 12'8"

22" x 36"
Attic Access

5SH

Bonus Room
22'0" x 24'4"

42" H Kneewall